



PARK DISTRICT

East Lansing, MI

BUILDING C - View from Abbot & Albert looking North



9-26-2014
1308-05



PARK DISTRICT

East Lansing, MI

BUILDING C - View from Albert looking East



9-26-2014
1308-05



PARK DISTRICT
East Lansing, MI

BUILDING D - View from Albert looking East



9-26-2014
1308-05



PARK DISTRICT

East Lansing, MI

BUILDING D - View from Valley Court Park looking East



9-26-2014
1308-05



PARK DISTRICT

East Lansing, MI

BUILDING E - View from Abbot looking North



9-26-2014
1308-05

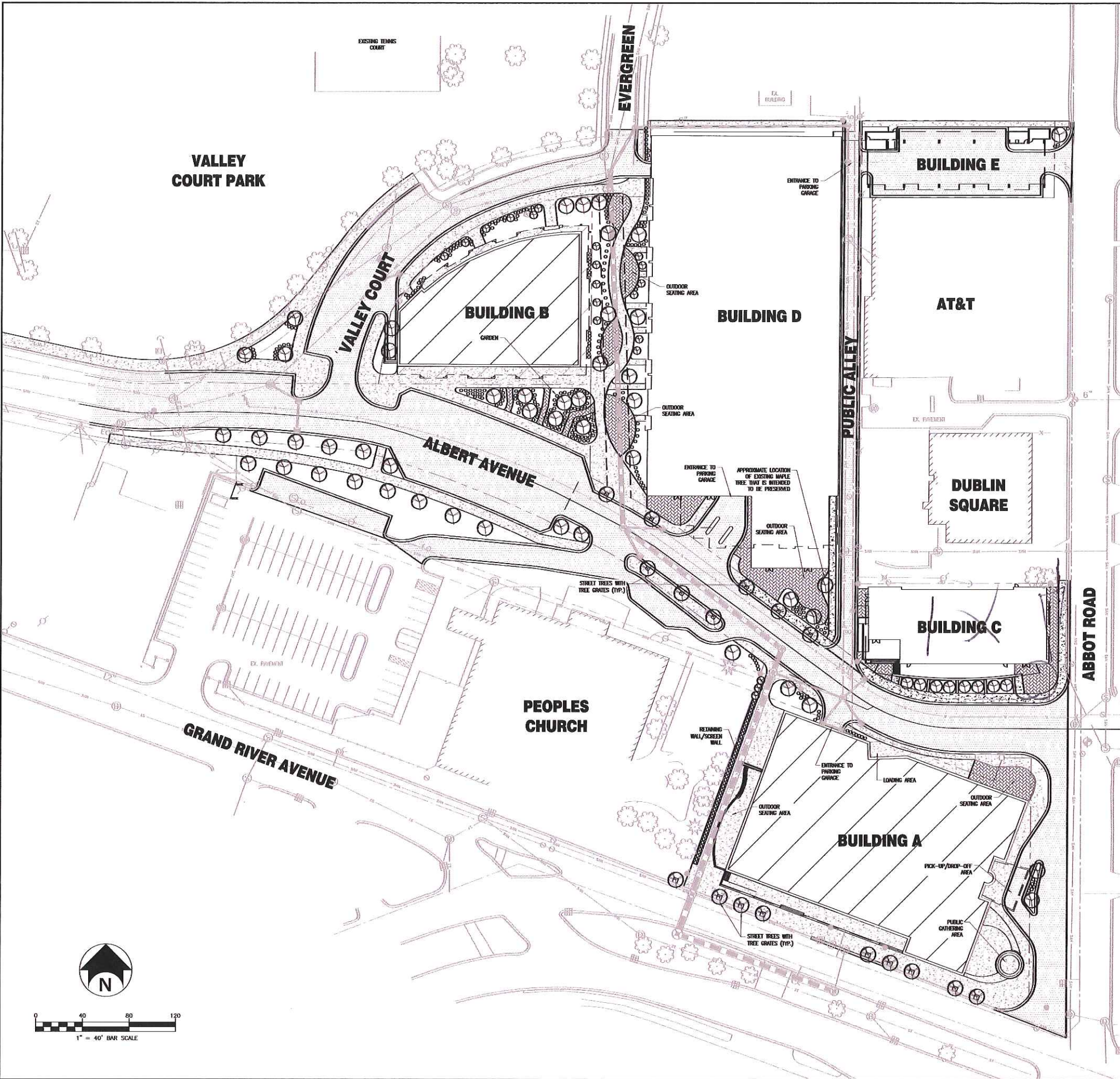

BENCHMARKS:

Benchmark #1: Big arm of fire hydrant on North side of Valley Court across from #248 West Grand River Avenue (car wash).
Elevation: 846.65
Benchmark #2: Big arm of fire hydrant on North side of intersection of Evergreen Avenue and Albert Avenue.
Elevation: 853.44

PLANT LIST:

Key	Scientific Name	Common Name	Size
AC	Abies concolor	White Fir	6' M. min.
AF	Abies fraseri	Fraser Fir	
AS	Acer macrocarpum 'Green Mountain'	Green Mountain Sugar Maple	3 1/2' cal min.
AG	Aquilegia x grandiflora 'Autumn Brilliance'	Autumn Brilliance Sedgwick	3 1/2' cal min.
OC	Crataegus crue-collii var. 'Inermis' 'Crataegus'	Thornless Crataegus Hawthorn	3 1/2' cal min.
OD	Crataegus bibula 'Autumn Gold'	Autumn Gold Crataegus	3 1/2' cal min.
GT	Cladonia macrocarpa var. 'Inermis' 'Skyline'	Skyline Hemlock	6' M. min.
ST	Pinus strobus 'Dorset'	Black Hills Spruce	6' M. min.
PO	Pinus strobus	Serbian Spruce	6' M. min.
PC	Pinus strobus	Swiss Stone Pine	6' M. min.
PS	Pinus strobus	Eastern White Pine	6' M. min.
PD	Pinus strobus x canadensis 'Woodspice'	Woodspice Loblolly Pine Tree	3 1/2' cal min.
PM	Pseudotsuga menziesii	Douglas Fir	6' M. min.
CS	Pyrus calleryana 'Chardonnay Select'	Chardonnay Pear	3 1/2' cal min.
IT	Tilia tomentosa 'Starling'	Starling Silver Linden	3 1/2' cal min.
OF	Quercus rubra 'Fastigiata'	Columbian English Oak	3 1/2' cal min.
OR	Quercus rubra	Red Oak	3 1/2' cal min.
ZS	Zelkova serrata 'Village Green'	Village Green Zelkova	3 1/2' cal min.
BM	Bambusa multiplex 'Wolfer Law'	Wolfer Law Bamboo	36"
EA	Erythronium albidum 'Compadre'	Barnaby Ruff	36"
AC	Juniperus ch. 'Sea Green'	Sea Green Juniper	36"
VP	Viburnum P.E. 'Virens'	Double File Viburnum	36"
CK	Colonyville 'Nail Fennel'	Nail Fennel Grass	5 gal.
PH	Pennisetum thalassia	Beard Fescue Grass	5 gal.
PL	Pennisetum 'Little Bunny'	Little Bunny Grass	5 gal.

LANDSCAPING NOTES:

- ALL PLANTS MUST BE HEALTHY, VIGOROUS MATERIAL, FREE OF PESTS AND DISEASE.
- ALL PLANTS MUST BE SUITABLE FOR USE IN THE SOIL AND CLIMATE CONDITIONS OF THE PROJECT.
- ALL PLANTS MUST BE CONTAINER GROWN OR BULLED AND BURLAPPED AS INDICATED IN THE PLANT LIST.
- ALL TREES MUST BE STRAIGHT TRUNKED AND FULL HEADED AND MEET ALL REQUIREMENTS SPECIFIED.
- MULCH ALL PLANTINGS WITH SHEARED HARDWOOD BARK MULCH, TO A MINIMUM DEPTH OF FOUR INCHES.
- THE CONTRACTOR IS RESPONSIBLE FOR VERIFYING ALL QUANTITIES SHOWN ON THESE PLANS BEFORE PROCEEDING WITH THE WORK.
- THE CONTRACTOR IS RESPONSIBLE FOR FULLY MAINTAINING ALL PLANT MATERIALS (INCLUDING BUT NOT LIMITED TO: WATERING, SPRAYING, MULCHING, FERTILIZING, ETC) AND LAWN AREAS UNTIL THE WORK IS ACCEPTED IN TOTAL BY THE OWNER.
- ANY PLANT MATERIAL WHICH DIES, TURNS BROWN, OR DEFLORATES (PRIOR TO TOTAL ACCEPTANCE OF THE WORK) SHALL BE PROMPTLY REMOVED FROM THE SITE AND REPLACED WITH MATERIAL OF THE SAME SPECIES, QUANTITY, AND SIZE MEETING ALL PLANT LIST SPECIFICATIONS.
- THE CONTRACTOR SHALL COMPLETELY GUARANTEE ALL PLANT MATERIAL FOR A PERIOD OF TWO (2) YEARS BEGINNING ON THE DATE OF TOTAL ACCEPTANCE. THE CONTRACTOR SHALL PROMPTLY MAKE ALL REPLACEMENTS BEFORE THE END OF THE GUARANTEE PERIOD.
- STANDARDS SET FORTH IN "AMERICAN STANDARD FOR NURSERY STOCK" AREA 2001 (LATEST EDITION), REPRESENT GUIDELINE SPECIFICATIONS ONLY AND SHALL CONSTITUTE MINIMUM QUALITY REQUIREMENTS FOR PLANT MATERIAL.
- LOCATIONS OF EXISTING BURIED UTILITY LINES SHOWN ON THE PLANS ARE BASED UPON BEST AVAILABLE INFORMATION AND ARE TO BE CONSIDERED APPROXIMATE. IT SHALL BE THE RESPONSIBILITY OF THE CONTRACTOR TO VERIFY THE LOCATIONS OF ALL UNDERGROUND UTILITY LINES ADJACENT TO THE WORK AREA. THE CONTRACTOR IS RESPONSIBLE FOR THE PROTECTION ALL UTILITY LINES DURING THE CONSTRUCTION PERIOD. THE CONTRACTOR SHALL BE RESPONSIBLE FOR REPAIRING ANY AND ALL DAMAGE TO UTILITIES, STRUCTURES, AND SITE APPURTENANCES, ETC., WHICH OCCURS AS A RESULT OF THE LANDSCAPE CONSTRUCTION.
- ALL SHOULDER PLANTING BEDS SHALL BE HAND SPADE CUT.
- ALL DISTURBED/UNPROTECTED AREAS SHALL RECEIVE TOPSOIL TO A COMPACTED DEPTH OF 4", SEED, MULCH, AND WATER UNTIL A HEALTHY STAND OF GRASS IS OBTAINED.

LEGEND

- SHADE TREE
- ORNAMENTAL TREE
- SHRUBS/ORNAMENTAL GRASSES
- EVERGREEN

Park District

EAST LANSING, MI 48823



2502 Lake Lansing Rd.
Ste C, Lansing,
MI 48912

Bergmann
associates
architects // engineers // planners

1427 West Saginaw Street, Suite 200
East Lansing, Michigan 48823

office: 517.272.9835
fax: 517.272.9836

www.bergmannpc.com

REVISIONS			
NO.	DATE	DESCRIPTION	REV. CKD.
06/30/14	SPR SUBMITTAL		
09/26/14	REVISED SPR SUBMITTAL		

**PRELIMINARY
LANDSCAPE PLAN**



**Know what's below.
Call before you dig.**

NOT APPROVED:
THIS PLAN HAS NOT RECEIVED FINAL APPROVAL OF ALL
RELEVANT AGENCIES. THIS PLAN IS SUBJECT TO
REVISIONS UNTIL ALL APPROVALS ARE OBTAINED AND
SHOULD NOT BE USED FOR CONSTRUCTION PURPOSES.

Project Manager:
Designed by:
P. FURTAW
Drawn by:
A. HODARSE
Checked by:
P. FURTAW
Date Issued:
February 28, 2014
Scale:
1" = 40'
Project Number:
8043.00
File Name:
_L100DTH.DWG
Drawing Number:

L100